

GROUND LEVEL

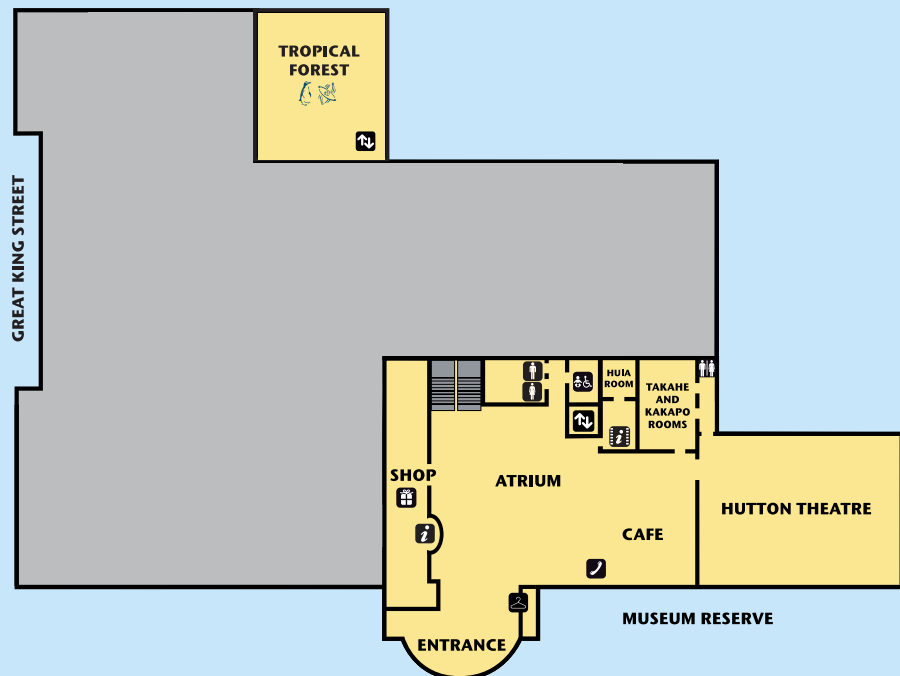

LEVEL 1

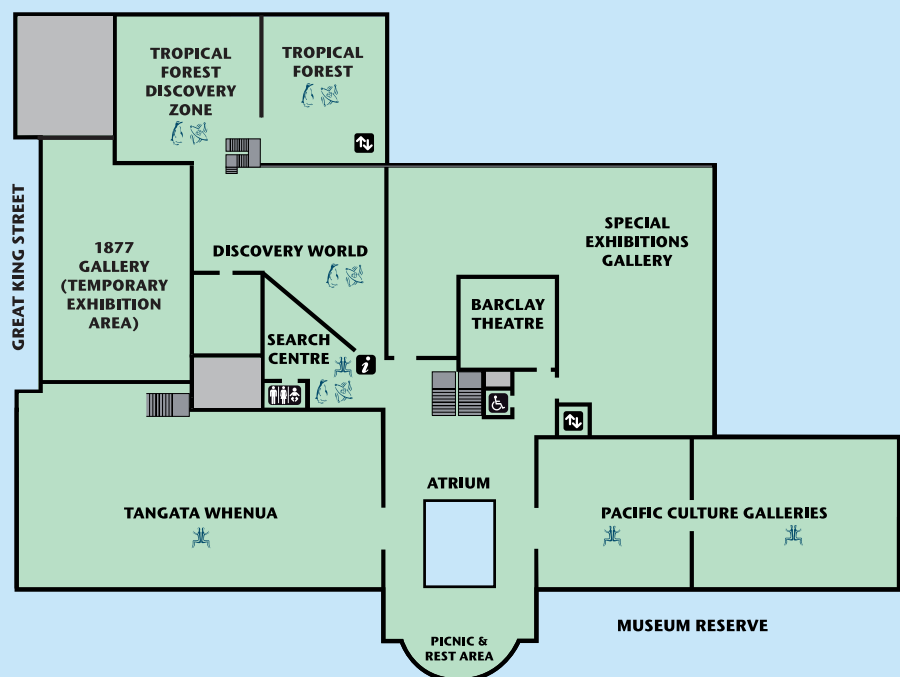

LEVEL 2, 3 & A

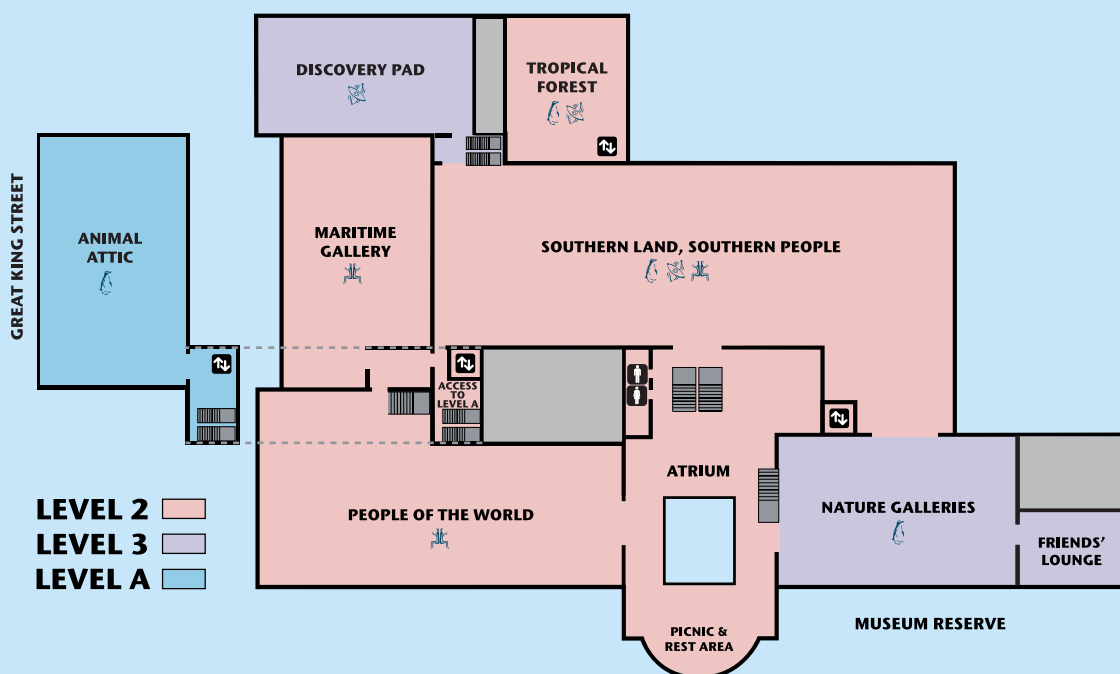

Key



INFORMATION DESK



CLOAKROOM



CHANGING ROOM



TOILETS



DISABLED ACCESS TOILET



STAIRS



LIFT



INTRODUCTORY VIDEO



MUSEUM SHOP



PUBLIC TELEPHONE

Predominant Stories

CULTURE

NATURE

SCIENCE

A Quick Tour

Ground

Our friendly Information Desk Communicator will share with you the details of exhibitions and programmes taking place in the Museum today and will be happy to help you plan your visit.

If this is your first time here, we recommend you spend a few minutes watching the Introductory Video in the foyer. Discover the richness and variety of experiences that await you in the galleries.

Admire the dramatic artwork hanging through three levels of the central Atrium. Created by local artist Marilyn Webb, the panels reflect the dynamic landscape of the spectacular Otago region.

At the beginning or end of your visit, take some time out to explore the **Museum Shop** and enjoy great coffee at the **Museum Café**.

Level 1

Gain an understanding of Māori culture and heritage through an amazing collection of taoka (treasures) in the **Tangata Whenua Gallery**. Appreciate precious pounamu (greenstone), an exceptional treasure of the South Island, and fine carvings by local iwi, Kāi Tahu, as well as from other iwi (tribes) around New Zealand.

Signposted by an extremely rare moai statue from Easter Island, the **Pacific Culture Galleries** include masks, tools and ceremonial objects from all over Polynesia and Melanesia. These Galleries showcase one of the best collections of Pacific Island material in the world.

Get hands-on in **Discovery World** and experience interactive science at its best, with exciting experiments and engaging exhibits for visitors of all ages. Then, encounter a rainforest teeming with tropical life... the **Tropical Forest** awaits you, with its lush gardens and live butterflies. A magical must-see! Admission charge applies.

Be sure to visit the current highlight in our regularly changing **Special Exhibitions Gallery**.

Inspired by something you've discovered and want to find out more? Embark on your own research with the help of our knowledgeable Communicator in the **Search Centre**. Take in a special programme or pick up an Explorer's Backpack for a family adventure.

The comfortable couches in the Atrium are a great place to relax. You are welcome to bring your own refreshments and picnic here, as well as upstairs on Level 2.

Level 2

For an introduction to Dunedin and Otago or to add to what you know, experience **Southern Land, Southern People**. Discover a collection and scholarship-rich gallery, featuring the special natural and human history stories of our past and present, and gain a window on the ingenious and enduring 'Southern character'.

The **Maritime Gallery** offers an extensive variety of intriguing and intricate ship models and nautical artefacts, telling an important part of New Zealand's story. Walk the length of our fin whale and imagine diving in a heavy Siebe-Gorman suit, used as recently as 1960!

An outstanding collection of Ancient Greek pottery, an Egyptian mummy, exquisite decorative arts, ceramics, swords, costumes and much more await in the **People of the World Gallery**, providing insight into cultures and traditions worldwide. Look out for our special exhibitions here as well.

Level 3

Discover Otago's special natural history in our **Nature Galleries**. You'll be amazed at the diversity and detail of the plants and animals to be found. Don't miss the chance to come face to face with an extinct giant moa!

Animal Attic

At the very top of the Museum you'll find a magnificent restored Victorian gallery, our **Animal Attic** - a truly magical museum within a museum. The Attic features an amazing collection of zoological specimens from around the world and is a favourite of visitors young and old.

Need to know

Q: Can I take pictures?

A: You're welcome to take photos for personal use. We ask you to help us look after our treasures by not using a flash. If you would like to take photos for publication, please make prior arrangements via our Marketing Officer.

Q: Where can I eat and drink?

A: We recommend a visit to the Museum Café. If you prefer to bring your own refreshments, please enjoy our picnic areas in the Atrium, on both Level 1 and 2. We ask you please not to take food and drink into the Galleries.

Q: What can I touch?

A: It's true that our treasures will be better preserved for the future if they are not touched. But there's plenty of hands-on fun to be had in Discovery World!